



Slide Reference Guide

Specifications at a Glance/ Cross Section Guide

Spring 2019

Accuride[®]
Always Moving Forward

Specification Table

	Model	Load Rating	Travel	Cross Section	Detent	Lock	Disconnect	Page
Electronic Enclosures	2807	100 lbs. [45 kg]	2" over [50.8 mm]	.38" [9.6 mm]	—	Out	Latch	9
	2907	115 lbs. [52 kg]	2" over [50.8 mm]	.38" [9.6 mm]	—	Out	Lever	9
	2907WB	120 lbs. [55 kg]	2" over [50.8 mm]	.38" [9.6 mm]	—	Out	Lever	10
	3507	200 lbs. [91 kg]	2" over [50.8 mm]	.50" [12.7 mm]	—	Out	Latch	10
Light-Duty Slides	2002 Two Way	50 lbs [23 kg]	3/4	.38" [9.6 mm]	Center	—	—	14
	2601	75 lbs. [34 kg]	Full	.50" [12.7 mm]	Hold-in	—	—	14
	3732	100 lbs. [45 kg]	Full	.50" [12.7 mm]	Hold-in	—	Push Latch	14
	3832E series	100 lbs. [45 kg]	Full	.50" [12.7 mm]	Hold-in	—	Lever	15
	0363 Two Way	100 lbs. [45 kg]	Full	.85" [21.6 mm]	Center	—	—	16
	201	108 lbs. [49 kg]	3/4	.38" [9.6 mm]	Hold-in	—	—	16
Medium-Duty Slides	204A-LR	140 lbs. [64 kg]	3/4	.38" [9.6 mm]	—	Out	Latch	18
	305A-LR	140 lbs. [64 kg]	Over	.75" [19.1 mm]	—	Out	Latch	18
	3301	150 lbs. [68 kg]	Over	.50" [12.7 mm]	—	—	—	19
	3307	150 lbs. [68 kg]	Over	.50" [12.7 mm]	—	Out	Latch	19
	3357	150 lbs. [68 kg]	Over	.50" [12.7 mm]	—	—	Latch	19
	3308	150 lbs. [68 kg]	Over	.50" [12.7 mm]	—	In and Out	Lever	19
	3634EC	150 lbs. [68 kg]	Over	.78" [19.8 mm]	Hold-in	—	Lever	19
	301-2590	155 lbs. [70 kg]	Over	.75" [19.1 mm]	Hold-in	—	—	19
Heavy-Duty Slides	301	175 lbs. [80 kg]	Over	.75" [19.1 mm]	—	—	—	21
	3601	225 lbs. [116 kg]	Over	.75" [19.1 mm]	Hold-in	—	—	21
	3600	273 lbs. [124 kg]	Full	.75" [19.1 mm]	Hold-in	—	—	22
	3607	273 lbs. [124 kg]	Full	.75" [19.1 mm]	—	Out	Lever	22
	3641	180 lbs. [82 kg]	Over	.89" [22.6 mm]	Hold-in	—	Rail	23
	3642	180 lbs. [82 kg]	Over	.89" [22.6 mm]	Hold-in	—	Rail	23
	3657	273 lbs. [124 kg]	Full	.75" [19.1 mm]	Hold-in	—	Lever	23
	7950	350 lbs. [159 kg]	Full	.75" [19.1 mm]	Hold-in	—	—	24
	7957	350 lbs. [159 kg]	Full	.75" [19.1 mm]	Hold-in	—	Lever	24
	9301E	600 lbs. [272 kg]	Full	.75" [19.1 mm]	Hold-in	—	—	25
	9307E	600 lbs. [272 kg]	Full	.75" [19.1 mm]	—	Out	—	26
	9308E	600 lbs. [272 kg]	Full	.75" [19.1 mm]	—	In and Out	—	26
	AL4160	661 lbs. [300 kg]	Full	1.04" [26.4 mm]	—	—	—	27
	AL4120	1,212 lbs. [550 kg]	3/4	1.42" [36 mm]	—	—	—	27
	AL4140	1,323 lbs. [600 kg]	Full	1.50" [38 mm]	—	—	—	27
Specialty Series Slides	FG115	900 lbs. [4000N]	Linear	.94 [24 mm]	—	—	—	29
	CB-Hand	Slide Dependent	—	—	—	In and Out	—	30
	AL4190 Tilt-Track System	—	—	—	—	—	—	31
	115RC	265 lbs. [120 kg]	Linear	.48" [12.3 mm]	—	—	—	32
	116RC	793 lbs. [360 kg]	Linear	.98" [25 mm]	—	—	—	33
	CBLift-0019 Ascent	14.5 lbs. [6.6 kg]	21" [538 mm]	—	—	—	—	34
	115	Mounting Dependent	Linear	.43" [11.1 mm]	—	—	—	35
	SS2028	100 lbs. [45 kg]	3/4	.38" [9.6 mm]	Hold-in	—	—	35
	SS0330	143 lbs. [65 kg]	Full	.75" [19.1 mm]	Hold-in	—	—	36
	SS5321	352 lbs. [160 kg]	Over	.75" [19.1 mm]	Hold-in	—	—	36
Pocket & Bayonet	2120	75 lbs. [34 kg]	3/4	.50" [12.7 mm]	Hold-in	—	Lever	41
	3820E	100 lbs. [45 kg]	Full	.50" [12.7 mm]	Hold-in	—	Lever	41
	3320	120 lbs. [55 kg]	Full	.50" [12.7 mm]	Hold-in	—	—	42
	3620	200 lbs. [91 kg]	Over	.75" [19.1 mm]	Hold-in	—	—	42
	9328E	360 lbs. [163 kg]	Full	.75" [19.1 mm]	—	In and Out	—	40
	9322E	360 lbs. [163 kg]	Full	.75" [19.1 mm]	—	—	—	40

To the design engineer:

This catalog is designed to assist you in making the proper slide selection for your application. The information listed on this spread provides an overview of the slides available and pertinent information to consider when selecting a slide. The following pages provide a more detailed look at slides and mounting hardware. Additional information, technical sheets, and specific design criteria is available at www accuride.com.

Factors to consider when selecting a slide

- Weight of chassis /drawer
- Side space available between chassis /drawer and rack/cabinet
- Height, width, and depth of chassis /drawer
- Depth of rack/cabinet
- Travel desired
- Application-specific requirements
- Disconnect of chassis /drawer needed
- Locks needed
- Mounting holes needed
- Optional mounting hardware for mounting in rack or enclosure

Cross sections and load ratings

Load rating range is based on slide length. For more information, see the slide tables in this catalog or download the technical sheets from [accuride.com](http://www accuride.com).

Electronic Enclosures

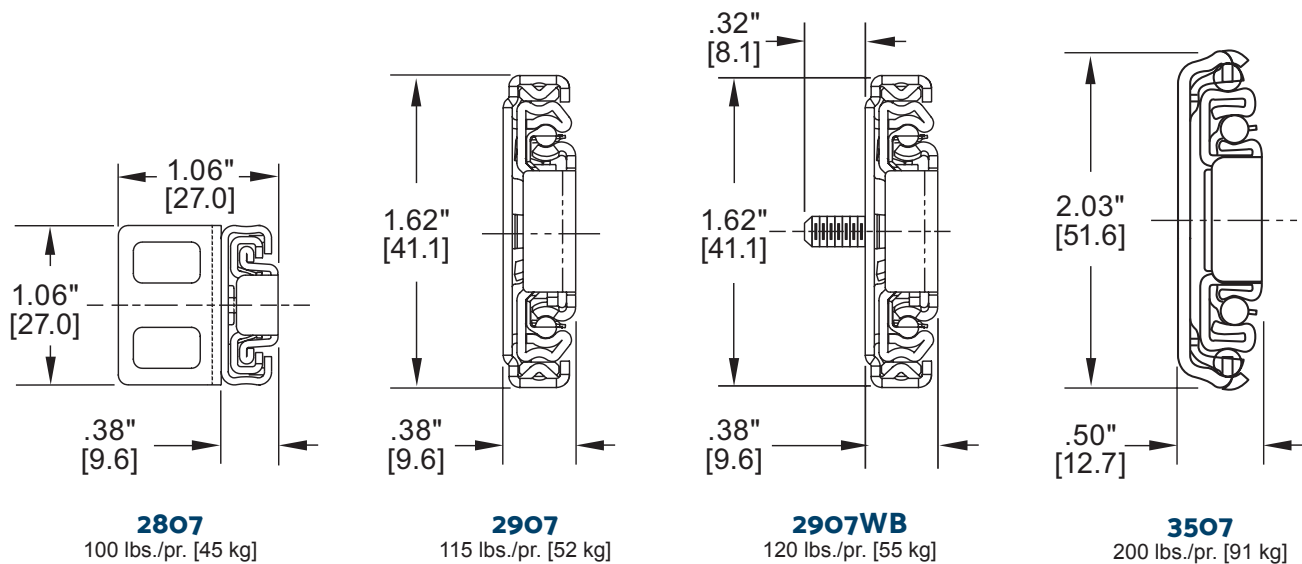

Light-Duty

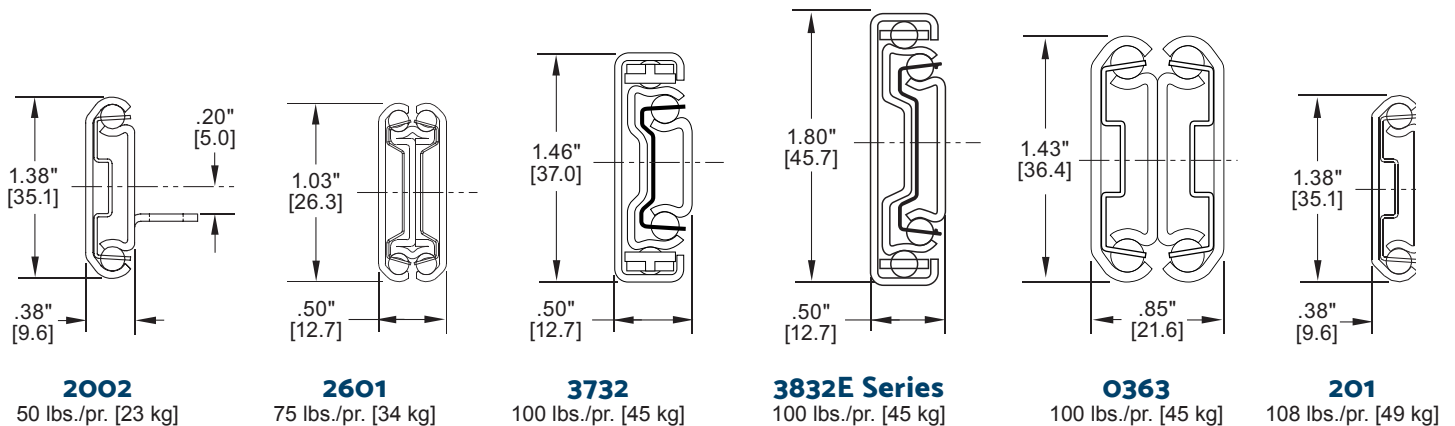

Medium-Duty

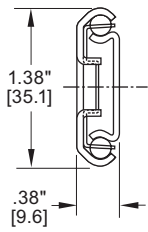

204A-LR
140 lbs./pr. [64 kg]

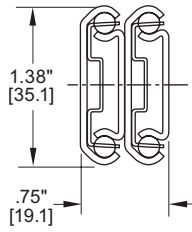

305A-LR
140 lbs./pr. [64 kg]

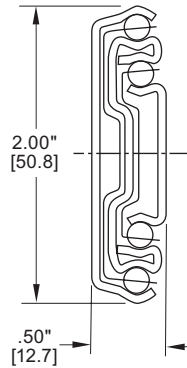

3301/3307/3308/3357
150 lbs./pr. [68 kg]

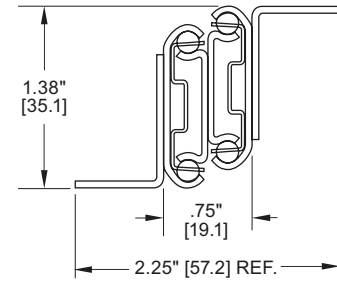

301-2590
155 lbs./pr. [70 kg]

Heavy-Duty

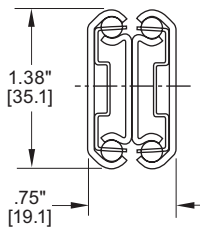

301
175 lbs./pr. [80 kg]

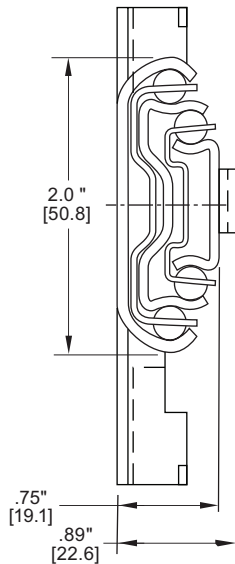

3641/3642
180 lbs./pr. [82 kg]

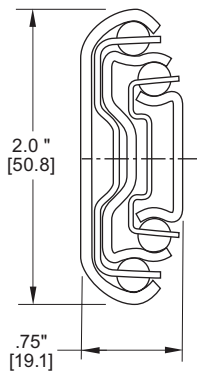

3601
255 lbs./pr. [116 kg]
3600/3607/3657
273 lbs./pr. [124 kg]

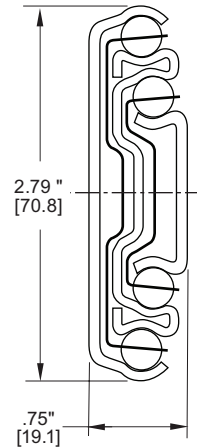

7950/7957
350 lbs./pr. [159 kg]

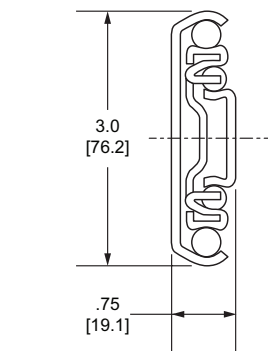
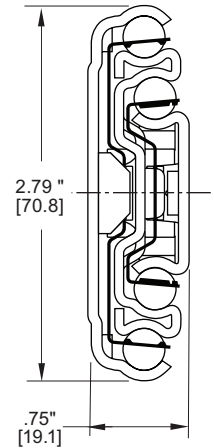

9301E/9307E/9308E
Up to 600 lbs./pr. [272 kg]*
* depending on usage

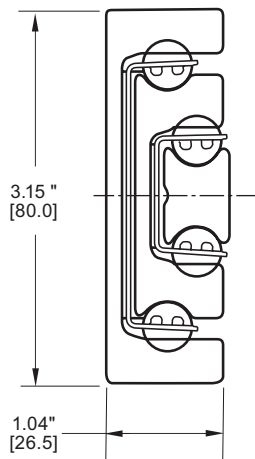

AL4160
Up to 661 lbs./pr. [300 kg]

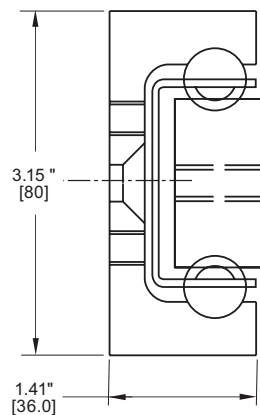

AL4120
Up to 1,212 lbs./pr. [550 kg]

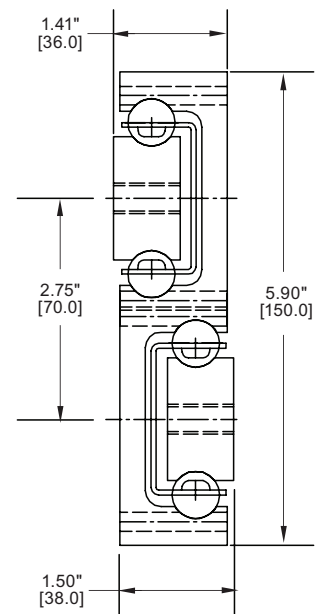

AL4140
Up to 1,323 lbs./pr. [600]

Pocket & Bayonet

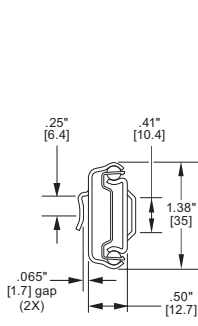

2120
Up to 75 lbs./pr. [50 kg]

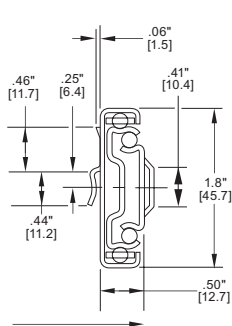

3820E
Up to 100 lbs./pr. [50 kg]

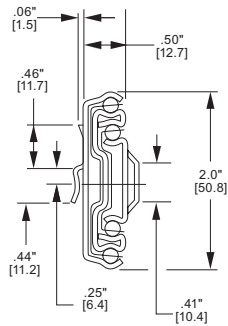

3320
Up to 120 lbs./pr. [55 kg]

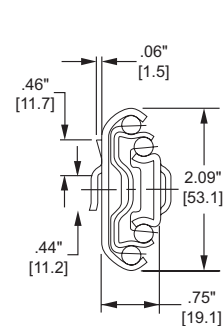

3620
Up to 200 lbs./pr. [91 kg]

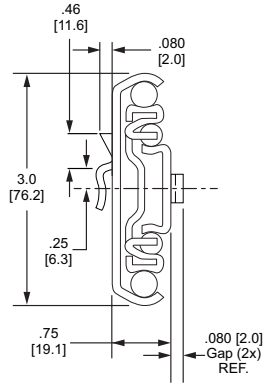

9328/9322
Up to 360 lbs./pr. [163 kg]
** depending on usage

Specialty Slide Products

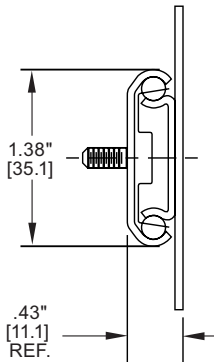

115
Side Mount: 100 lbs./pr. [50 kg]
Flat Mount: 132 lbs./pr. [60 kg]

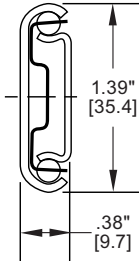

SS2028
100 lbs./pr. [50 kg]

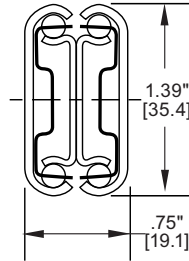

SS0330
143 lbs./pr. [65 kg]

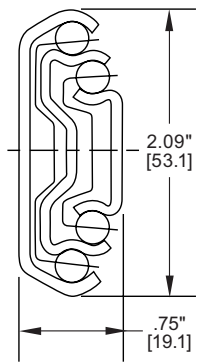

SS5321
352 lbs./pr. [160 kg]

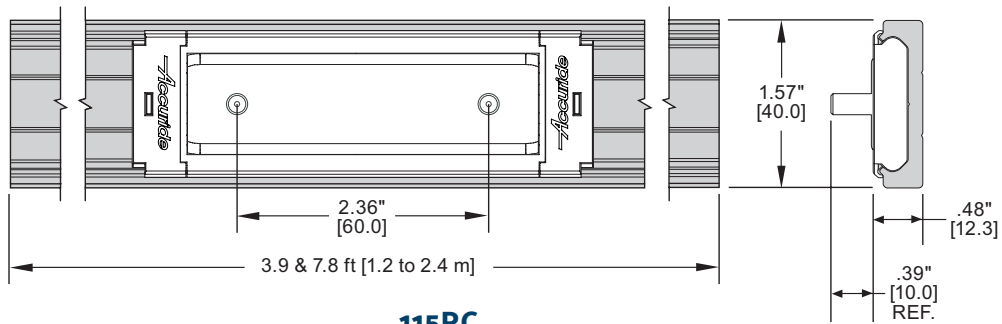

115RC
Up to 265 lbs. [120 kg]

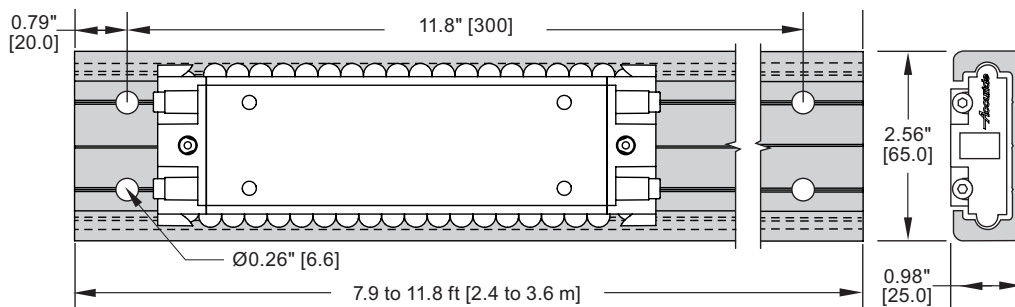

116RC
Up to 793 lbs. [360 kg]

Specialty Slide Products

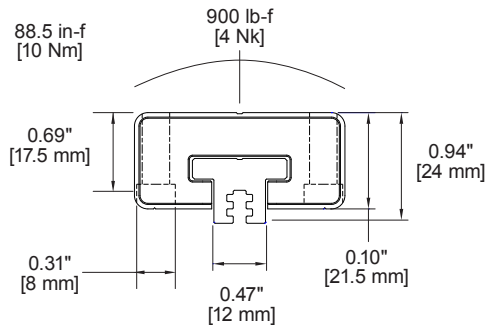

FG115
Side Mount: 900 lb-f [4000 N]

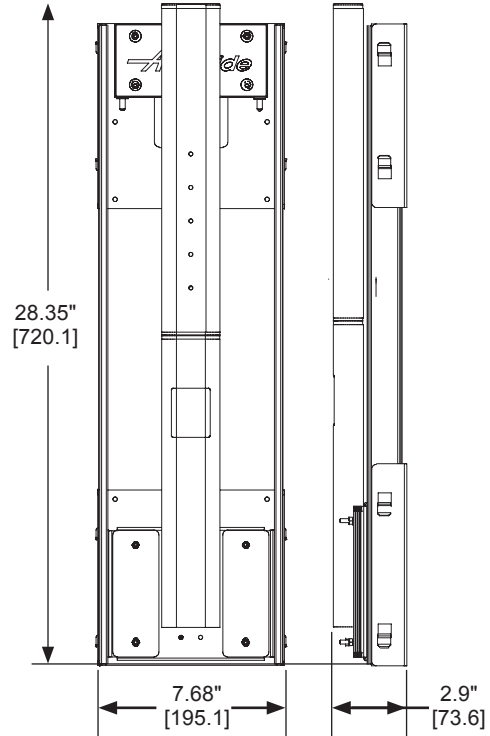

Ascent CBLift-0019
Up to 14.5 lbs. [6.6 kg]

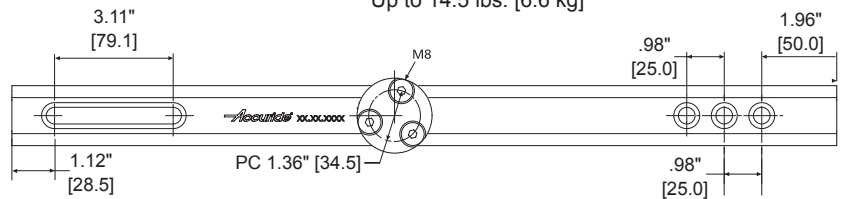
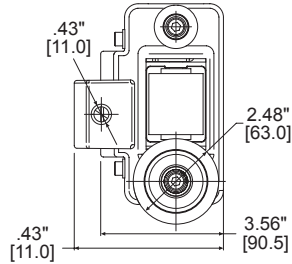
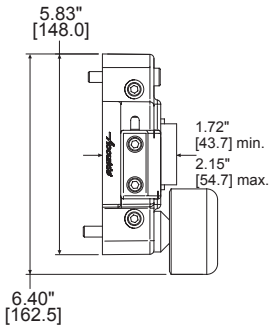

AL4190
Tilt Track System
Up to 140lbs. [63.5 kg]

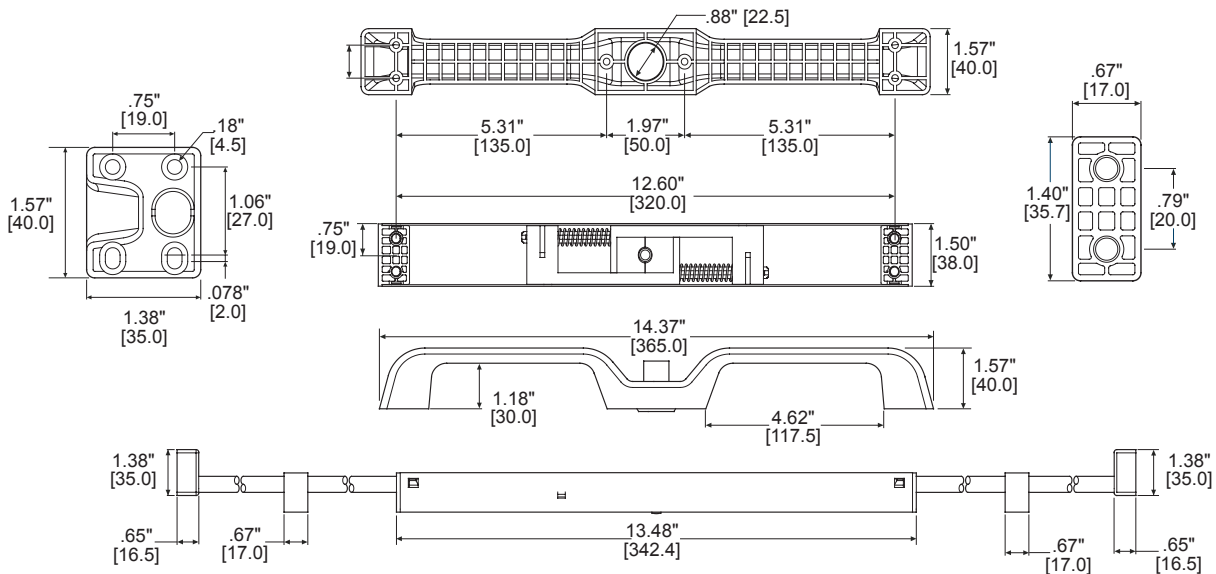

CB-Hand Locking Handle Kits
Drawers up to 60\"/>